

**FOR LEASE**

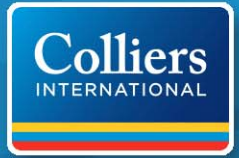

# Escondido Town & Country

1625–1665 E. Valley Parkway, Escondido, Ca 92027



## Property / Area Description

- Located at signalized E. Valley Pkwy & Rose St intersection
- Monument and building signage available
- Retail suites available from ~750SF to ~2,000SF

## Demographics

	1 mile	2 mile	3 mile
2009 Population	34,724	81,396	116,015
2009 Avg HSHD	\$59,830	\$64,780	\$68,060

## Traffic Counts

E. Valley Parkway (2006)	26,000
Rose Street (2006)	13,000

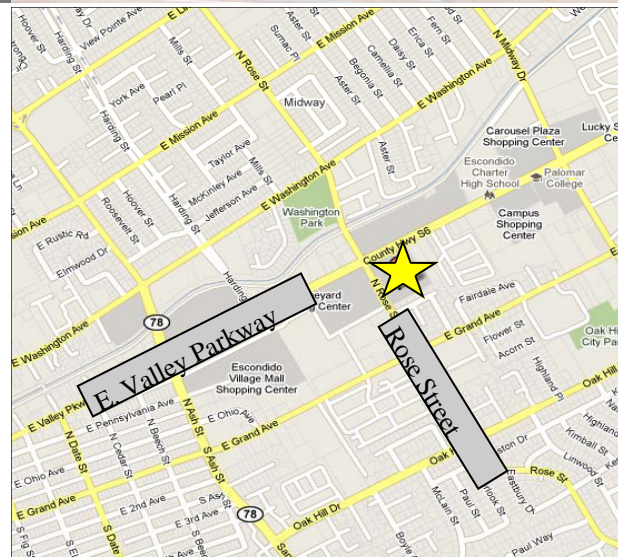

BILL BARNETT  
760 930 7934  
CARLSBAD, CA  
bill.barnett@colliers.com  
Lic# 00797620

DOUG HOGAN  
760 930 7935  
CARLSBAD, CA  
doug.hogan@colliers.com  
Lic# 00931530

COLLIERS INTERNATIONAL  
5901 Priestly Drive, Suite 100  
Carlsbad, CA 92008  
www.colliers.com/carlsbad

**FOR LEASE**

# Escondido Town & Country

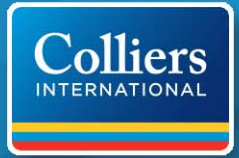

1625–1665 E. Valley Parkway, Escondido, Ca 92027

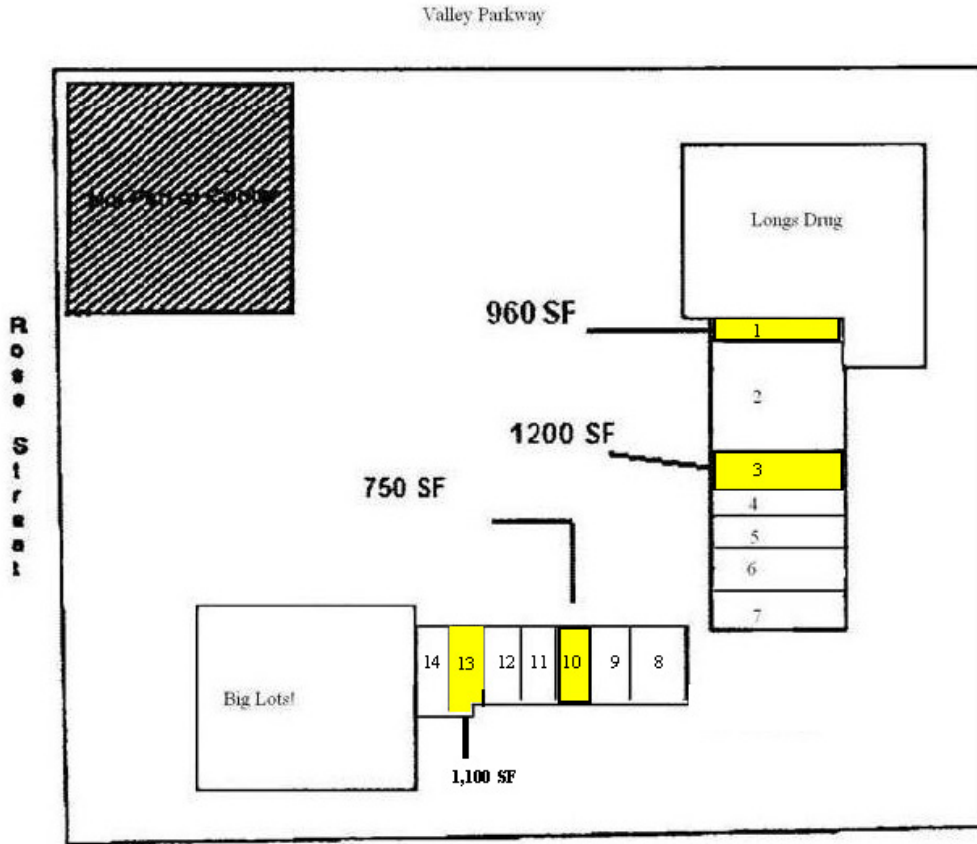

ID	SUITE #	TENANT	SQUARE FEET
1	1663	AVAILABLE	960
2	1655	Navy Federal Credit Union	5,280
3	1651	AVAILABLE	1,200
4	1649	Nice Cut	960
5	1657	Dentist	960
6	1643	Kiday Spa	2,160
7	1641	Laundry	1800

ID	SUITE #	TENANT	SQUARE FEET
8	1639	Restaurant	2000
9	1637	Postal Annex	750
10	1635	AVAILABLE	750
11	1633	Nail Salon	750
12	1631	Vitamins	960
13	1629	AVAILABLE	1,100
14	1627	Pizza	1,100

BILL BARNETT  
760 930 7934  
CARLSBAD, CA  
bill.barnett@colliers.com  
Lic# 00797620

DOUG HOGAN  
760 930 7935  
CARLSBAD, CA  
doug.hogan@colliers.com  
Lic# 00931530

COLLIERS INTERNATIONAL  
5901 Priestly Drive, Suite 100  
Carlsbad, CA 92008  
www.colliers.com/carlsbad